



## Part 1 - Contributions

### Financial (\$\$) Contributions – Named

*The names and addresses of people or organizations that gave money to your campaign, and the amount of money they gave.*

- ✓ If you know the name of anyone who gave money to your campaign, you must record it.
- ✓ \$2,500 is the maximum allowed per person or organization.
- ✓ The financial agent may issue a tax receipt to every eligible person or organization who contributed money.

Contributor's Name	Contributor's Address	Tax Receipt #	Contribution Amount
			\$
			\$
			\$
			\$
			\$
			\$
			\$
			\$
			\$
			\$
			\$
			\$
			\$
			\$
			\$
			\$
			\$
<b>Total Financial Contributions – Named</b> (put this amount on line 1 on page 10)			<b>\$</b>

## Anonymous Financial (\$\$) Contributions

*This is money that came from people that you don't know who they were.*

- ✓ You can only receive a maximum of \$100 per anonymous contribution. If it is more than \$100, you must either find out who gave it to you and return it, or send it to the Chief Electoral Officer.
- ✓ The total combined limit for all anonymous contributions is \$2,500. Any amount over \$2,500 must be returned to the contributor or sent to the Chief Electoral Officer.

Date of Anonymous Contribution	Contribution (\$\$) Amount
	\$
	\$
	\$
	\$
	\$
	\$
	\$
	\$
	\$
	\$
	\$
	\$
	\$
	\$
	\$
	\$
	\$
	\$
	\$
	\$
	\$
<b>Total Anonymous Contributions</b> (put this amount on line 2 on page 10)	\$

## Financial (\$\$) Contributions from the Candidate (Not Reimbursed)

*This is the amount of personal money the Candidate spent on the Campaign that was not reimbursed.*

- ✓ The candidate can contribute more than \$2,500 to their campaign.
- ✓ A candidate may only be issued a tax receipt to a maximum of \$2500, even if they contributed more.

Date and detail of Personal \$\$ Contribution	Receipt #	Personal Contribution (\$\$) Amount
		\$
		\$
		\$
		\$
		\$
		\$
		\$
		\$
		\$
		\$
		\$
		\$
		\$
		\$
<b>Total Personal \$\$ Contribution</b> (put this amount on line 3 on page 10)		\$

## Campaign Gathering Financial (\$\$) Contributions

*Money your campaign received at a campaign gathering.*

**Named Contributions:** The name and addresses of people or organizations that gave money to your campaign, and the amount of money they gave.

**Anonymous Contributions:** Money that came from people you don't know who they were.

<b>Named Contributions - Campaign Gathering</b>			
<b>Contributor's Name</b>	<b>Contributor's Address</b>	<b>Tax Receipt #</b>	<b>Contribution (\$\$) Amount</b>
			\$
			\$
			\$
			\$
			\$
			\$
<b>Campaign Gathering Total Financial Contributions – Named</b>			<b>\$</b>

<b>Anonymous Contributions - Campaign Gathering</b>	
<b>Date of Anonymous Contribution</b>	<b>Contribution (\$\$) Amount</b>
	\$
	\$
	\$
	\$
<b>Campaign Gathering Total Contributions- Anonymous</b>	<b>\$</b>

<b>Total Campaign Gathering Contributions Named + Anonymous</b> (put this amount on line 4 on page 10)	<b>\$</b>
---	-----------

## Goods & Services Contributions

These are contributions your campaign received that was not money. You must reasonably estimate and record the market value of the goods and services.

- ✓ \$2500 in market value is the maximum allowed per person or organization, unless it is for transportation or accommodation services during the election.
- ✓ Volunteer labour is not considered a contribution, unless the volunteer would usually charge for the service they are providing the campaign.

**Market value** means what something would cost if you had to pay for it.

- If someone donates a pair of mitts that you use as a door prize for your campaign gathering, the price those mitts would normally have sold for would be their market value.
- If a company donates airline tickets or accommodations, the market value would be what that ticket or accommodation would normally have cost.

Contributor's name and address	Detail of Contribution	Market Value
		\$
		\$
		\$
		\$
		\$
		\$
		\$
		\$
		\$
		\$
		\$
		\$
		\$
		\$
<b>Total Goods &amp; Services Contributions</b> (put this amount on line 5 on page 10)		\$

## Part 2 - Expenses

### Campaign Expenses

Goods & Services Expenses				
Supplier's name	Detail of Expense	Invoice #	Receipt #	Market Value
Kitikmeat Foods	Country Food	10909		\$ 727.71 ✓
Kalens Dis + Dat Inc	Lumber for	2200001261860		\$ 328.60 ✓
Hamlet of Cambridge Bay	Elders Palace Rental Oct 9/25		R4057524	\$ 114.50 ✓
Hamlet of Cambridge Bay	Hall Rental October 17/25		R4057525	\$ 604.25 ✓
IKaluktutiat Coop				\$ 667.75 ✓
Northern Stores				\$ 358.22 ✓
				\$
				\$
<b>Total Goods &amp; Services Expenses</b> (put this amount on line 6 on page 10)				\$ 2801.03 ✓

Childcare & Disability Expenses				
Supplier's name	Detail of Expense	Invoice #	Receipt #	Expense \$
				\$
				\$
				\$
				\$
				\$
				\$
<b>Total Childcare &amp; Disability Expenses</b> (put this amount on line 7 on page 10)				\$

Advertising Expenses				
Supplier's name	Detail of Expense	Invoice #	Receipt #	Expense \$
Vista Print	Door hangers, Pens Posters, Cards, Notebooks	VP-G 16NATCG		\$ 786.85 ✓
Tcepik Media	Re-election Video	000067		\$ 315.00 ✓
Lena Seams	Custom Pins	G1-45		\$ 1000.00 ✓
Anish Parmar		APGD-25-002		\$ 1875.00 ✓
				\$
				\$
				\$
				\$
				\$
				\$
				\$
<b>Total Advertising Expenses</b> (put this amount on line 8 on page 10)				\$ 3976.85 ✓

Salaries & Allowances				
Supplier's name	Detail of Expense	Invoice #	Receipt #	Expense \$
				\$
				\$
				\$
				\$
				\$
<b>Total Salaries &amp; Allowances</b> (put this amount on line 9 on page 10)				\$

Office Rent & Utilities				
Supplier's name	Detail of Expense	Invoice #	Receipt #	Expense \$
				\$
				\$
				\$
<b>Total Office Rent &amp; Utilities</b> (put this amount on line 10 on page 10)				\$

Travel & Accommodations				
Supplier's name	Detail of Expense	Invoice #	Receipt #	Expense \$
				\$
				\$
				\$
				\$
				\$
<b>Total Travel &amp; Accommodations</b> (put this amount on line 11 on page 10)				\$

Other Expenses				
Supplier's name	Detail of Expense	Invoice #	Receipt #	Expense \$
				\$
				\$
				\$
				\$
				\$
<b>Total Other Expenses</b> (put this amount on line 12 on page 10)				\$

## Part 3 - Summary of Contributions and Expenses

### Campaign Contributions

Line	Contribution Description	Amount
1	Financial (\$\$) Contributions - Named	\$
2	Financial Contributions (\$\$) - Anonymous	\$
3	Candidate's Personal Contribution - Not Reimbursed	\$
4	Campaign Gathering - Named + Anonymous	\$
5	Goods & Services Contributions	\$
6	<b>Total Campaign Contributions</b>	<b>\$</b>

### Campaign Expenses

Line	Expense Description	Amount
6	Goods & Services	\$ 2801.03
7	Childcare & Disability Expenses	\$
8	Advertising Expenses	\$ 3976.85
9	Salaries & Allowances	\$
10	Office Rent & Utilities	\$
11	Travel & Accommodations	\$
12	Other Expenses	\$
13	<b>Total Campaign Expenses</b>	<b>\$ 6,777.88</b>

14. Total Campaign Contributions-----	\$	0
15. Total Campaign Expenses-----	\$	6,777.88
16. Surplus or (deficit)-----	\$	(6,777.88)

Note: Line 14 – Line 15 enter on Line 16

- (a) If the number is positive (+) it is surplus
- (b) If the number is negative (-) it is deficit (please enter the number in brackets e.g. (302.07))

Checklist for Financial Agent and Candidate	Financial Agent's initial	Candidate's initial	Elections Nunavut
<input type="checkbox"/> All parts of the form are completed and signed			
<input type="checkbox"/> Receipts for every expense, including unpaid expenses			
<input type="checkbox"/> Printed statements from bank or approved institution			
<input type="checkbox"/> CEO approvals for any expenses over \$30,000			
<input type="checkbox"/> All tax receipts/books and Record of Tax Receipts form returned to Elections Nunavut.			
<input type="checkbox"/> Closure of Account statement, showing a zero balance			
<input type="checkbox"/> If there is a surplus- <i>having money left over after the election</i> - you will issue a cheque to the Government of Nunavut or to a charitable organization. Provide a copy of the cheque and receipt with this return.			

Privacy Statement: *The information in the campaign financial return is collected and published under the authority of the Nunavut Elections Act. Questions can be directed to: Chief Privacy Officer, Elections Nunavut [privacy@elections.nu.ca](mailto:privacy@elections.nu.ca) or by calling toll free 1-800-267-4394.*

## Part 4 - Declaration

**By signing the declaration, both the candidate and financial agent expressly declare that:**

- ✓ We understand that this financial return will be audited if we received or spent more than \$500 on the campaign. The audit will determine whether it presents fairly the information contained in the accounting records on which the return is based pursuant to s. 181.1 of the *Nunavut Elections Act*.
- ✓ We have not violated the Nunavut Elections Act in respect of this election.
- ✓ We have not withheld any information from our records and documents relevant to this election.
- ✓ All contributions to the campaign were accepted by either the financial agent; or Pamela Hakongak-Gross who was authorized in writing to accept contributions on behalf of the financial agent. (*print full name(s) of any authorized person*)
- ✓ No contributions to the campaign over \$2,500.00 were accepted, except transportation and accommodation services given as a goods or services contribution.
- ✓ We accepted no contributions prohibited under the *Nunavut Elections Act*.
- ✓ Any contributions in excess of the limits under the *Nunavut Elections Act* were either returned to the contributor or paid (in amount or value) to the Chief Electoral Officer.
- ✓ No contributions to the campaign was used for any purpose other than to pay an election expense for the candidate.
- ✓ All contributions of money to the campaign were deposited into the campaign bank account or approved institution.
- ✓ No person other than the financial agent issued any tax receipts for contributions to the campaign.
- ✓ All tax receipts issued for contributions to the campaign were issued from the receipt book provided by Elections Nunavut and faithfully show who made the contribution and not any other person or organization.
- ✓ No gifts or other advantages were accepted that might reasonably be seen to influence the candidate, if elected.
- ✓ No person other than the financial agent, or a person authorized in writing by the financial agent, incurred any election expense for the campaign.

- ✓ There are no legal claims and possible claims against the candidate or financial agent in respect of this election, except as follows: *(provide details of any claims or possible claims)*

None

---



---



---

- ✓ We have disclosed in this return any facts relating to any fraud or suspected fraud that may impact this financial return. The details of any facts relating to any fraud that may impact this financial return are as follows: *(provide details of any facts relating to any fraud or suspected fraud)*

---



---



---

DECLARATION BY CANDIDATE	DECLARATION BY FINANCIAL AGENT
<p>I solemnly declare that I reviewed this financial return and that it is accurate, complete and does not contain any false or misleading information.</p> <p>I make this solemn declaration knowing that it is of the same force and effect as if made under oath pursuant to the <i>Nunavut Evidence Act</i>.</p>	<p>I solemnly declare that I reviewed this financial return and that it is accurate, complete and does not contain any false or misleading information.</p> <p>I make this solemn declaration knowing that it is of the same force and effect as if made under oath pursuant to the <i>Nunavut Evidence Act</i>.</p>
<p>At (community): <u>Cambridge Bay</u></p>	<p>At (community): <u>Cambridge Bay</u></p>
<p>Date: <u>Dec. 17, 2025</u></p>	<p>Date: <u>Dec 17, 2025</u></p>
<p>X <u><i>Pam Or</i></u> <b>Signature of Candidate</b></p>	<p>X <u><i>[Signature]</i></u> <b>Signature of Financial Agent</b></p>
<p>X <u><i>[Signature]</i></u> <b>Signature of Commissioner of Oaths, Justice of the Peace, Notary Public or RCMP</b></p>	<p>X <u><i>[Signature]</i></u> <b>Signature of Commissioner of Oaths, Justice of the Peace, Notary Public or RCMP</b></p>

Ikaluktutiak Co-op  
Cambridge Bay  
Nunavut X0B 0C0  
Phone: 867 983-2201  
Fax: 867 983-2085  
GST 102452885RT

Sale Tx#1426866 2025-10-11 12:51:28

Customer:

Pamela Gross

03338366401	CARROTS CELLO EA	6.39
	Includes NNC savings: 2.76	
060200107763	NAB GRD RST COFF	42.99
063211283617	CAMP CHUNKY NE C	8.99
063211283617	CAMP CHUNKY NE C	8.99
031200444998	O/SPRAY WHL CRAP	3.99
	Includes NNC savings: 0.92	
4072	POTATO BAKER RUS	26.93
	2.995 kg @ \$8.99/1KG	
	Includes NNC savings: 9.09	
068700103612	DAIRYLAND CREAMO	10.29
	Includes NNC savings: 1.49	
19056910095	GG PEACHES & CRE	3.59
	Includes NNC savings: 0.80	
063211283617	CAMP CHUNKY NE C	8.99
01920099366	LYSOL WIPES SPRG	15.99 G
066188043901	STOVE TOP STUFF	3.79
4663	ONION WHITE JUMB	2.66
	0.580 kg @ \$4.59/1KG	
	Includes NNC savings: 1.76	
10008	MEAT EA	65.00
5731621144	C.GOLD PCHS N CR	8.99
	Includes NNC savings: 2.43	
10008	MEAT EA	69.20
10008	MEAT EA	63.74

**Item Count : 16**

Subtotal	350.52
Goods and Services (15.99)	0.80
Bottle Deposit	0.00

**Total 351.32**

Amex	200.00
Amex	151.32

Store: 10 Station: 2 Cashier: 969

Your cashier today was Karissa

Thank you!

Nutrition North Canada  
brought to you by INAC and  
your community Co-op

making nutritious food more affordable  
Subsidy 1 \$3.05 /KG Subsidy 2 \$1.40 /KG  
Subsidy 7 \$3.25 /KG Subsidy 8 \$1.90 /KG

\*\*\*\*\*  
\* NNC Program has saved you up to \*  
\* \$19.25 on your purchase today \*  
\*\*\*\*\*

The Co-op is committed to passing on  
the full NNC subsidy to consumers.  
Displayed NNC Savings may be based  
on average weights where individual  
weights are not available, and  
savings on select random weight,  
in-store packaged, and miscellaneous  
item sales may not be available.

----- TRANSACTION RECORD -----  
**IKALUKTUTIAK CO-OP**  
0 BOX 38  
CAMBRIDGE BAYNU

## Purchase

Oct 11, 2025	11:54:40
AMEX	*****
TID: ****315	Entry: Tap EMV (H)
Sequence: 159 042	
Auth#: 801123	Response: 00-025
Batch: 159	

Amount	\$ 5.76
--------	---------

<b>Total</b>	<b>\$ 5.76</b>
--------------	----------------

A000000025010801  
AMERICAN EXPRESS  
TVR 0000008000

**Approved**  
Signature Not Required

Important: Retain this copy for your record

Cardholder copy

Ikaluktutiak Co-op  
Cambridge Bay  
Nunavut X0B 0C0  
Phone: 867 983-2201  
Fax: 867 983-2085  
GST 102452885RT

Sale Tx#1426867 2025-10-11 12:54:29

Customer:

Pamela Gross

05209202014 HANDI FOIL UP RO 5.49 G

**Item Count: 1**

Subtotal	5.49
Goods and Services (5.49)	0.27
Bottle Deposit	0.00

**Total 5.76**

Amex 5.76

Store: 10 Station: 2 Cashier: 969

Your cashier today was Karissa

Thank you!

Nutrition North Canada  
brought to you by INAC and  
your community Co-op

making nutritious food more affordable  
Subsidy 1 \$3.05 /KG Subsidy 2 \$1.40 /KG  
Subsidy 7 \$3.25 /KG Subsidy 8 \$1.90 /KG

Ikaluktutiak Co-op  
Cambridge Bay  
Nunavut X0B 0C0  
Phone: 867 983-2201  
Fax: 867 983-2085  
GST 102452885RT

Sale Tx#1429273 2025-10-16 19:29:43

Customer:

Pamela Gross

056188061905 COOL WHIP -Z 1 11.99  
056188061905 COOL WHIP -Z 1 11.99  
5796101778 SRYPE BL 100% AP 17.99  
Includes NNC savings: 7.51  
05731618769 C.GOLD COCONUT U 8.39  
600699060783 JET PUFF MINI FR 3.99  
600699060783 JET PUFF MINI FR 3.99  
87471800627 OCEAN MAMA CLAMM 7.99  
Includes NNC savings: 1.03  
058400001539 OXO /KNORR CHICK 5.39  
13056942327 GG SWEETLET PEAS 6.49  
Includes NNC savings: 2.54  
5731621144 C.GOLD PCHS N CR 8.99  
Includes NNC savings: 2.43  
057316001245 CO-OP GLD MANDRI 1.99  
Includes NNC savings: 0.68  
057316001245 CO-OP GLD MANDRI 1.99  
Includes NNC savings: 0.68  
057316001245 CO-OP GLD MANDRI 1.99  
Includes NNC savings: 0.68  
5731609244 CO-OP GOLD PINEA 3.49  
Includes NNC savings: 1.00  
5731609244 CO-OP GOLD PINEA 3.49  
Includes NNC savings: 1.00  
057316001245 CO-OP GLD MANDRI 1.99  
Includes NNC savings: 0.68  
6509612370 LACT GARLIC BUTT 4.49  
Includes NNC savings: 0.39  
05601359862 GAY LEA BUTTER S 10.99  
Includes NNC savings: 1.38  
63152907772 LEMONS BAGGED 2 10.99  
Includes NNC savings: 2.95  
058700100468 DAIRYLAND 18% CR 6.49  
Includes NNC savings: 0.80  
03338346287 POTATO RED 5LB C 9.99  
Includes NNC savings: 6.90  
5335451080 J CLOTHS REUSABL 9.99 G  
4093 ONIONS YELLOW JU 5.09  
0.850 kg @ \$5.99/1KG  
Includes NNC savings: 2.58

**Item Count : 23**

Subtotal 160.17  
Goods and Services (9.99) 0.50  
Bottle Deposit 0.00

**Total 160.67**

Amex 160.67

Store: 10 Station: 3 Cashier: 78

Your cashier today was BEATRICE

Thank you!

Nutrition North Canada  
brought to you by INAC and  
your community Co-op

making nutritious food more affordable  
Subsidy 1 \$3.05 /KG Subsidy 2 \$1.40 /KG  
Subsidy 7 \$3.25 /KG Subsidy 8 \$1.90 /KG

\*\*\*\*\*  
\* NNC Program has saved you up to \*  
\* \$33.23 on your purchase today \*  
\*\*\*\*\*

The Co-op is committed to passing on  
the full NNC subsidy to consumers

----- TRANSACTION RECORD -----  
**IKALUKTUTIAK CO-OP**  
0 BOX 38  
CAMBRIDGE BAYNU

## Purchase

Oct 16, 2025 18:32:01  
AMEX \*\*\*\*\*  
TID: \*\*\*\*\*182 Entry: Tap EMV (H)  
Sequence: 150 054  
**Auth#: 804085** Response: 00-025  
Batch: 150

Amount \$ 160.67

**Total \$ 160.67**

A000000025010801  
AMERICAN EXPRESS  
TVR 0000008000

**Approved**  
Signature Not Required

Important: Retain this copy for your record

Cardholder copy

THANK YOU  
FOR SHOPPING AT  
**Northern**

General Delivery  
Cambridge Bay, NU  
867-983-2571

GST # R808425870

Office Supplies

Plu# 6666069157  
Staples Standard 7.49 G  
Plu# 315414354311  
Stapler 32.99 G

Total 40.48

TAX-CODE	TAXABLE-VAL	TAX-VALUE
GST	40.48	2.02

BALANCE DUE 42.50  
AMEX 42.50  
Auth # 809171 Ref # 0021578540

CHANGE 0.00

\*\* TRANSACTION RECORD \*\*  
Tran. #: 8159  
Invoice #: 0021578540

Purchase  
Card Type: AM  
Card #:  
xxxxxxxxxx> RF

Amount CAD\$42.50

NWS15002 000 (000)  
Auth. #: 809171  
Reference #: 001231140  
Trace ID:014481957351071  
09/29/2025 3:52:09 PM

AMERICAN EXPRESS  
AID: A000000025010801  
TSI: A800

00 APPROVED - THANK YOU

Customer Copy

Retain this copy for  
your records

Total number of items sold = 2

CASHIER NAME: Analuna  
C0014 #1578 13:52:10 29SEP2025  
S02150 R002

NNC - Making Healthy Food  
More affordable  
Nutrition North Savings Applied  
on Eligible Items  
NNC Subsidy 1 \$3.05/kg  
NNC Subsidy 2 \$1.40/kg  
NNC Subsidy 7 \$3.25/kg  
RETURNS WITHIN 30  
DAYS WITH RECEIPT  
NO RETURNS ON GIFTCARDS

# THANK YOU FOR SHOPPING AT Northern

General Delivery  
Cambridge Bay, NU  
867-983-2571

GST # R808425870

Baking

Plu# 5900001652  
Robin Hood Flour B 19.99  
Includes NNC Subsidy 19.61  
Plu# 6310019911  
Tenderflake Lard B 19.49  
Includes NNC Subsidy 4.50  
Plu# 6620090401  
CH Gravy Mix B 3.39  
Plu# 6710000491  
Magic Baking Powder B 9.09  
Includes NNC Subsidy 0.98

Fresh Vegetables

Plu# 3338365301  
Celery Hearts EACH B 8.99  
Includes NNC Subsidy 2.00

Kitchen Disposab

Plu# 5921231222  
iEco Bagasse Bow B 5.59 G  
Plu# 5921231222  
iEco Bagasse Bow B 5.59 G  
Plu# 5921231222  
iEco Bagasse Bow B 5.59 G  
Plu# 5921231222  
iEco Bagasse Bow B 5.59 G  
Plu# 5921231441  
Cafe Express Cup B 5.09 G  
Plu# 5921231441  
Cafe Express Cup B 5.09 G

**Total 93.49**

TAX-CODE	TAXABLE-VAL	TAX-VALUE
GST	32.54	1.63

**BALANCE DUE 95.12**  
AMEX 95.12  
Auth # 829292 Ref # 0025428167

CHANGE 0.00

\*\* TRANSACTION RECORD \*\*  
Tran. #: 5018  
Invoice #: 0025428167

Purchase  
Card Type: AM  
Card #:  
xxxxxxxxxxxx RF  
Amount CAD\$95.12

NWS15002 000 (000)  
Auth. #: 829292  
Reference #: 001243068  
Trace ID:016245275120064  
10/11/2025 2:12:41 PM

AMERICAN EXPRESS  
AID: A000000025010801  
TSI: A800

00 APPROVED - THANK YOU

Customer Copy

Retain this copy for  
your records

Total number of items sold = 11

TOTAL SAVINGS

# THANK YOU FOR SHOPPING AT Northern

General Delivery  
Cambridge Bay, NU  
867-983-2571

GST # R808425870

## Fresh Meat

Lean Ground Beef	B	
0.790 kg @ 24.79/kg		19.58
Includes NNC Subsidy		2.43
Lean Ground Beef	B	
0.848 kg @ 24.79/kg		21.02
Includes NNC Subsidy		2.61
<b>Total</b>		<b>40.60</b>

**BALANCE DUE** 40.60  
Debit 40.60  
Auth # 008735 Ref # 0039764714

CHANGE 0.00

## \*\* TRANSACTION RECORD \*\*

Tran. #: 25501  
Invoice #: 0039764714

## Purchase

Card Type: DP

Card #:

XXXXXXXXXXXX RF

Amount CAD\$40.60

NWS15003 001 (001)  
Auth. #: 008735  
Reference #: 001242043  
10/12/2025 4:44:48 PM

## INTERAC

AID: A0000002771010

TSI: 2800

00 APPROVED - THANK YOU

Customer Copy

Retain this copy for  
your records

Total number of items sold = 2

TOTAL SAVINGS

-----

-----

CASHIER NAME: Sarah  
C0022 #9764 14:44:49 12OCT2025  
S02150 R003

NNC - Making Healthy Food  
More affordable  
Nutrition North Savings Applied  
on Eligible Items  
NNC Subsidy 1 \$3.05/kg  
NNC Subsidy 2 \$1.40/kg  
NNC Subsidy 7 \$3.25/kg  
RETURNS WITHIN 30  
DAYS WITH RECEIPT  
NO RETURNS ON GIFTCARDS

# THANK YOU FOR SHOPPING AT Northern

General Delivery  
Cambridge Bay, NU  
867-983-2571

GST # R808425870

Pasta/Rice/Dried

PTu# 72529903034

Tilda Basmati Rice B 22.49

Includes NNC Subsidy 3.52

Total 22.49

**BALANCE DUE 22.49**

AMEX 22.49

Auth # 800356 Ref # 0027119711

CHANGE 0.00

\*\* TRANSACTION RECORD \*\*

Tran. #: 31405

Invoice #: 0027119711

Purchase

Card Type: AM

Card #:

XXXXXXXXXXXX RF

Amount CAD\$22.49

NWS15002 000 (000)

Auth. #: 800356

Reference #: 001248183

Trace ID:013816955354307

10/16/2025 8:42:50 PM

AMERICAN EXPRESS

AID: A000000025010801

TSI: A800

00 APPROVED - THANK YOU

Customer Copy

Retain this copy for  
your records

Total number of items sold = 1

TOTAL SAVINGS

CASHIER NAME: Savanna  
C0024 #7119 18:42:52 16OCT2025  
S02150 R002

NNC - Making Healthy Food  
More affordable  
Nutrition North Savings Applied  
on Eligible Items  
NNC Subsidy 1 \$3.05/kg  
NNC Subsidy 2 \$1.40/kg  
NNC Subsidy 7 \$3.25/kg  
RETURNS WITHIN 30  
DAYS WITH RECEIPT  
NO RETURNS ON GIFTCARDS

# THANK YOU FOR SHOPPING AT Northern

General Delivery  
Cambridge Bay, NU  
867-983-2571

GST # R808425870

## Fresh Vegetables

Plu# 4663  
Onions White KG B  
0.375 kg @ 11.99/kg 4.50  
Includes NNC Subsidy 1.19

## Kitchen Disposab

Plu# 5735101250  
Alcan Foil 12x50 B 10.49 G  
Plu# 5921299736  
Titan Pans and Lids B 6.29 G  
Plu# 5921299736  
Titan Pans and Lids B 6.29 G  
Plu# 5921299736  
Titan Pans and Lids B 6.29 G

Total 33.86

TAX-CODE	TAXABLE-VAL	TAX-VALUE
GST	29.36	1.47

BALANCE DUE 35.33  
AMEX 35.33  
Auth # 865894 Ref # 0027146743

CHANGE 0.00

\*\* TRANSACTION RECORD \*\*  
Tran. #: 1541  
Invoice #: 0027146743

Purchase  
Card Type: AM  
Card #:  
xxxxxxxxxxx RF  
Amount CAD\$35.33

NWS15002 000 (000)  
Auth. #: 865894  
Reference #: 001249016  
Trace ID:013749052918320  
10/17/2025 12:25:01 PM

AMERICAN EXPRESS  
AID: A000000025010E01  
TSI: A800

00 APPROVED - THANK YOU

Customer Copy

Retain this copy for  
your records

Total number of items sold = 5

TOTAL SAVINGS

CASHIER NAME: Savarina  
CO024 #7146 10:25:06 17OCT2025  
S02150 R002

NNC - Making Healthy Food  
More affordable  
Nutrition North Savings Applied  
on Eligible Items  
NNC Subsidy 1 \$3.05/kg  
NNC Subsidy 2 \$1.40/kg  
NNC Subsidy 7 \$3.25/kg  
RETURNS WITHIN 30  
DAYS WITH RECEIPT  
NO RETURNS ON GIFTCARDS

# THANK YOU FOR SHOPPING AT Northern

General Delivery  
Cambridge Bay, NU  
867-983-2571

GST # R808425870

Fresh Meat

Lean Ground Beef	B	
0.886 kg @ 24.79/kg		21.96
Includes NNC Subsidy		2.73
Lean Ground Beef	B	
0.862 kg @ 24.79/kg		21.37
Includes NNC Subsidy		2.65

Fresh Vegetables

Plu# 3338346290		
Potatoes	B	12.99
Includes NNC Subsidy		7.19

Frz Vegetables/F

Plu# 6038386700		
Mixed Vegetables	B	5.89
Includes NNC Subsidy		2.56

Kitchen Disposab

Plu# 5870378322		
NN Paper Plates	B	11.59 G
Plu# 5870378322		
NN Paper Plates	B	11.59 G
Plu# 5870378322		
NN Paper Plates	B	11.59 G

Pasta/Rice/Dried

Plu# 6806202118		
Italpasta Elbows	B	5.99
Includes NNC Subsidy		1.83

Soups

Plu# 6321114816		
Campbell's Soup	B	8.29

**Total 111.26**

TAX-CODE	TAXABLE-VAL	TAX-VALUE
GST	34.77	1.74

<b>BALANCE DUE</b>	<b>113.00</b>
AMEX	113.00
Auth # 805059	Ref # 0027273855
CHANGE	0.00

\*\* TRANSACTION RECORD \*\*  
Tran. #: 2787  
Invoice #: 0027273855

Purchase  
Card Type: AM  
Card #:  
XXXXXXXXXX RF  
Amount CAD\$113.00

NWS15002 000 (000)  
Auth. #: 805059  
Reference #: 001249105  
Trace ID: 013754097261322  
10/17/2025 4:02:56 PM

AMERICAN EXPRESS  
AID: A000000025010601  
TSI: A800

00 APPROVED - THANK YOU

Customer Copy

Retain this copy for  
your records

Total number of items sold = 9

TOTAL SAVINGS

**THANK YOU  
FOR SHOPPING AT  
Northern**

General Delivery  
Cambridge Bay, NU  
867-983-2571

GST # R808425870

Soups

Plu# 6840009121  
Lipton On Soup B 4.59  
Plu# 6840009121  
Lipton On Soup B 4.59

**Total 9.18**

**BALANCE DUE 9.18**

AMEX 9.18

Auth # 800615 Ref # 0030582472

CHANGE 0.00

**\*\* TRANSACTION RECORD \*\***

Tran. #: 13759

Invoice #: 0030582472

Purchase

Card Type: AM

Card #:

XXXXXXXXXX> RF

Amount CAD\$9.18

NWS15003 000 (000)

Auth. #: 800615

Reference #: 001247078

Trace ID:013830851936307

10/17/2025 6:10:09 PM

AMERICAN EXPRESS

AID: A000000025010801

TSI: A800

00 APPROVED - THANK YOU

Customer Copy

Retain this copy for  
your records

Total number of items sold = 2

CASHIER NAME: Laura  
C0015 #0582 16:10:09 17OCT2025  
S02150 R003

NNC - Making Healthy Food  
More affordable  
Nutrition North Savings Applied  
on Eligible Items  
NNC Subsidy 1 \$3.05/kg  
NNC Subsidy 2 \$1.40/kg  
NNC Subsidy 7 \$3.25/kg  
RETURNS WITHIN 30  
DAYS WITH RECEIPT  
NO RETURNS ON GIFTCARDS

----- TRANSACTION RECORD -----  
**IKALUKTUTIAK CO-OP**  
**0 BOX 38**  
**CAMBRIDGE BAYNU**

## **Cash Purchase**

Oct 16, 2025

19:20:12

TID: \*\*\*\*\*031

Amount

\$ 150.00

### **Approved**

Cardholder conu

----- TRANSACTION RECORD -----  
**IKALUKTUTIAK CO-OP**  
**0 BOX 38**  
**CAMBRIDGE BAYNU**

## **Gift Activation**

Oct 16, 2025 19:19:38  
ARCTIC COOPERATIVES  
803838\*\*\*\*\*3344  
TID: \*\*\*\*\*031 - \*\*\*958 Batch: 46  
Auth#: 142790181 Response: 000

<b>Amount</b>	<b>\$ 50.00</b>
<b>Balance Due</b>	<b>\$ 50.00</b>
Card Balance	\$ 50.00

## **Approved**

Merchant copy

----- TRANSACTION RECORD -----  
**IKALUKTUTIAK CO-OP**  
**□ BOX 38**  
**CAMBRIDGE BAYNU**

## **Gift Activation**

Oct 16,2025 19:19:38  
ARCTIC COOPERATIVES  
\*\*\*\*\*3344  
TID: \*\*\*\*\*031 - \*\*\*958 Batch: 46  
Auth#: 142790181 Response: 000

<b>Amount</b>	<b>\$ 50.00</b>
<b>Balance Due</b>	<b>\$ 50.00</b>
<b>Card Balance</b>	<b>\$ 50.00</b>

## **Approved**

Cardholder copy

----- TRANSACTION RECORD -----  
IKALUKTUTIAK CO-OP  
0 BOX 38  
CAMBRIDGE BAYNU

## Gift Activation

Oct 16, 2025 19:18:20  
ARCTIC COOPERATIVES  
\*\*\*\*\*3338  
TID: \*\*\*\*\*031 - \*\*\*958 Batch: 46  
Auth#: 142790172 Response: 000

<b>Amount</b>	<b>\$ 50.00</b>
<b>Balance Due</b>	<b>\$ 50.00</b>
<b>Card Balance</b>	<b>\$ 50.00</b>

### Approved

Cardholder copy

----- TRANSACTION RECORD -----  
**IKALUKTUTIAK CO-OP**  
**0 BOX 38**  
**CAMBRIDGE BAYNU**

## **Gift Activation**

Oct 16, 2025 19:18:58  
ARCTIC COOPERATIVES  
\*\*\*\*\*3328  
TID: \*\*\*\*\*031 - \*\*\*958 Batch: 46  
Auth#: 142790157 Response: 000

<b>Amount</b>	<b>\$ 50.00</b>
<b>Balance Due</b>	<b>\$ 50.00</b>
<b>Card Balance</b>	<b>\$ 50.00</b>

## **Approved**

Cardholder copy

----- TRANSACTION RECORD -----  
**IKALUKTUTIAK CO-OP**  
**0 BOX 38**  
**CAMBRIDGE BAYNU**

## Purchase

Oct 11, 2025	11:54:20
AMEX	*****
TID: ****315	Entry: Tap EMV (H)
Sequence: 159 041	
<b>Auth#: 867401</b>	Response: 00-025
Batch: 159	

Amount	\$ 151.32
--------	-----------

<b>Total</b>	<b>\$ 151.32</b>
--------------	------------------

A000000025010801  
AMERICAN EXPRESS  
TVR 0000008000

**Approved**  
Signature Not Required

Important: Retain this copy for your record

Cardholder copy

-----TRANSACTION RECORD-----  
**IKALUKTUTIAK CO-OP**  
**0 BOX 38**  
**CAMBRIDGE BAYNU**

## Purchase

Oct 11, 2025	11:53:57
AMEX	*****
TID: ****315	Entry: Tap EMV (H)
Sequence: 159 040	
<b>Auth#: 827474</b>	Response: 00-025
Batch: 159	

Amount	\$ 200.00
--------	-----------

<b>Total</b>	<b>\$ 200.00</b>
--------------	------------------

A000000025010801  
AMERICAN EXPRESS  
TVR 0000008000

**Approved**  
Signature Not Required

Important: Retain this copy for your record

Cardholder copy

## Lena Egotak

---

**From:** Lena Egotak  
**Sent:** December 10, 2025 9:28 AM  
**To:** Lena Egotak  
**Subject:** Fwd: Your order is confirmed

Sent from my iPhone

Begin forwarded message:

**From:** Pamela Gross  
**Date:** December 9, 2025 at 4:28:22 PM MST  
**To:** Lena Egotak  
**Subject:** Fwd: Your order is confirmed

----- Forwarded message -----

**From:** VistaPrint <[no-reply@t.vistaprint.ca](mailto:no-reply@t.vistaprint.ca)>  
**Date:** Wed, Sep 24, 2025 at 4:43 PM  
**Subject:** Your order is confirmed  
**To:** Pamela Gross

Order Confirmation



Thank you for your order, Pamela.

We're processing it now and we will let you know when it's on its way. Please be aware that the items in your order may be sent in multiple packages and arrive separately.

Expected delivery: Wednesday, October 1, 2025 - Friday, October 3, 2025

[Check order status](#)





Posters

Quantity: 75

Expected delivery: Wed, 1 October

~~\$157.00~~ \$136.54



Posters

Quantity: 50

Expected delivery: Wed, 1 October

~~\$219.00~~ \$190.47



Standard Postcards

Quantity: 100

Expected delivery: Wed, 1 October

~~\$27.00~~ \$23.48

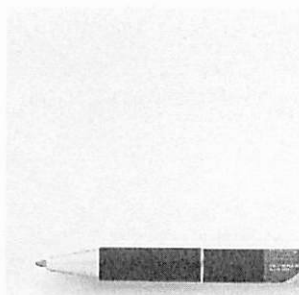

VistaPrint® Design Wrap Ballpoint Pen

Quantity: 60

Expected delivery: Wed, 1 October

~~\$140.20~~ \$121.93



Custom Notebooks

Quantity: 3

Expected delivery: Wed, 1 October

~~\$28.00~~ \$24.35

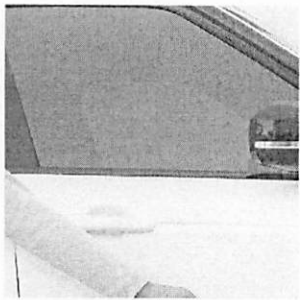

Car Magnets

Quantity: 2

Expected delivery: Fri, 3 October

~~\$43.19~~ \$37.56

### Order summary

Subtotal	\$767.39
Savings  NEW20	-\$100.00
Delivery: Express	\$81.99
Tax	\$37.47

---

Total \$786.85

**Some ideas for next time:**



Foam Boards ▶



Car Magnets ▶

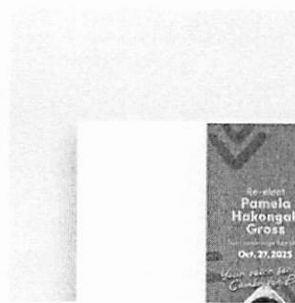

Standard Postcards ▶

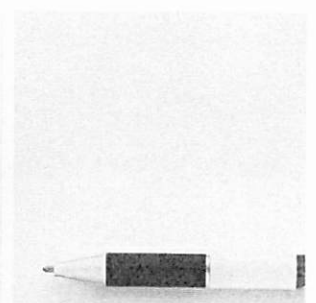

VistaPrint® Design Wrap Ballpoint Pen ▶

Any images featuring your own design are visible only to you.



Need help? Get in touch with our customer care team.

This email is automatically generated, please do not reply.

All products and services are provided by Vistaprint Canada Corporation, 333 Bay Street, Suite 2400, Toronto, ON, M5H 2T6, Canada.

[Privacy Policy](#) | [Terms of Use](#) | [Contact & Support](#)

a CIMPRESS company





**Icepik Media**

New Invoice

**\$315.00**

Due on October 26, 2025

**Pay Invoice**

**Pamela Gross - Re-election videos**

Invoice #000067

October 26, 2025

**Customer**

Pamela Gross

**Date of service**

October 26, 2025

[Download Invoice PDF](#)

**Message**

3 short videos, 30 to 45 seconds each, each aimed at a specific audience. Highlighting your results, especially the education piece for the 30 to 40 age group, and also touch on your platform, election promises, and maybe a short FAQ to really show your dedication to the people of Cambridge Bay.

**Invoice summary**

<b>Videography</b>	<b>\$300.00</b>
--------------------	-----------------

Subtotal	\$300.00
GST	\$15.00
<b>Total Due</b>	<b>\$315.00</b>

**Icepik Media**

icepikmedia@gmail.com

(819) 230-9299

GST/HST: 784023632RT0001

Please contact Icepik Media about its privacy practices.

## Lena Egotak

---

**From:** Lena Egotak  
**Sent:** December 10, 2025 9:27 AM  
**To:** Lena Egotak  
**Subject:** Fwd: Invoice# SI-45 from LenaSseams  
**Attachments:** Sales\_Invoice\_SI-45\_LenaSseams.pdf

Sent from my iPhone

Begin forwarded message:

**From:** Pamela Gross  
**Date:** December 9, 2025 at 4:34:24 PM MST  
**To:** Lena Egotak  
**Subject:** Fwd: Invoice# SI-45 from LenaSseams

----- Forwarded message -----

**From:** LenaSseams <[donotreply@sbc.sage.com](mailto:donotreply@sbc.sage.com)>  
**Date:** Tue, Sep 30, 2025 at 2:02 PM  
**Subject:** Invoice# SI-45 from LenaSseams  
**To:**

## LenaSseams

### INVOICE SI-45

TOTAL  
**\$1,000.00**

DUE DATE  
**10/30/2025**

[View Invoice](#)

Thank you for your business - we're pleased to attach your invoice in PDF.  
Full details, including payment terms, are included.  
If you have any questions, please don't hesitate to contact us.

Kind regards,

LenaSseams

8674459886

[lenasseams@outlook.com](mailto:lenasseams@outlook.com)

[www.lenasseams.ca](http://www.lenasseams.ca)

POWERED BY

Sage



**Deliver To**  
Iqaluit NU

# Invoice

Number: SI-45  
Issued: 30 Sep 2025  
Due: 30 Oct 2025

**Pamela Gross**  
Iqaluit NU

LenaSseams  
8 Amagok Street, PO Box 248  
Kugluktuk NU X0B 0E0  
Canada  
8674459886  
lenasseams@outlook.com

Item	Qty/Hrs	Price/Rate	Sales Tax	Net
Custom 2.5" Pin      Custom 2.5" Pin	200.00	5.00	No Tax	1,000.00
<b>Comments</b> Custom Pins, free pick up or delivery within Edmonton.				Total Net      1,000.00
				Invoice Total      1,000.00
				<b>Total to Pay      \$1,000.00</b>

# ANISH PARMAR

Senior UI/UX + Graphic Designer

Client: Pamela Hakongak Gross Campaign

PAMELA GROSS

Invoice Number: APGD-25-0002

Date: 12/10/2025

Services Overview: Campaign Material Design and Production

Client PO Number: N/A

Work Breakdown	Time (hrs)	Item Cost
Posters (ENG/INU)	6	750.00
Button Pins (ENG/INU)	2.5	312.50
Door Hangers (ENG/INU)	5	625.00
Open House Posters	1.5	187.50

Payment: SUBTOTAL

\$1875.00

Tax (13%):

-

**TOTAL COST:**

**\$1875.00**

Anish Parmar will expect full payment of the above cost within 30 days of the date of this invoice

Cash

Cheque No.: .....

Cheque

Date (DD/MM/YYYY): .....

Please make cheques payable to: **ANISH PARMAR**  
or send email money transfers to **anish.s.parmar@gmail.com**

**ANISH PARMAR**

527 Rioja St. | Stittsville, ON | Canada | K2S 0V9

www.anishparmar.com

anish.s.parmar@gmail.com | 613.266.5463

KITIKMEOT FOODS LTDQCO  
15 MITIK ST  
CAMBRIDGE BAYNT

CARD \*\*\*\*\*  
CARD TYPE AMEX  
DATE 2025/10/16  
TIME 7870 16:45:24  
RECEIPT NUMBER  
H84101856-001-088-013-0

-----  
PURCHASE  
TOTAL

\$127.71  
-----

AMERICAN EXPRESS  
A000000025010801  
C0638008232D4899  
0000008000-E800

**APPROVED**

AUTH# 823809 00-025  
THANK YOU

**NO SIGNATURE REQUIRED**

CARDHOLDER COPY

IMPORTANT - RETAIN THIS  
COPY FOR YOUR RECORDS

KITIKMEOT FOODS LTDQCO  
15 MITIK ST  
CAMBRIDGE BAYNT

CARD \*\*\*\*\*  
CARD TYPE AMEX  
DATE 2025/10/16  
TIME 5594 16:44:36  
RECEIPT NUMBER  
H84101856-001-088-012-0

-----  
PURCHASE  
TOTAL

\$200.00  
-----

AMERICAN EXPRESS  
A000000025010801  
36AD33A76500B7C0  
0000008000-E800

**APPROVED**

AUTH# 803120 00-025  
THANK YOU

**NO SIGNATURE REQUIRED**

CARDHOLDER COPY

IMPORTANT - RETAIN THIS  
COPY FOR YOUR RECORDS

KITIKMET FOODS LTDQCO  
15 MITIK ST  
CAMBRIDGE BAYNT

CARD \*\*\*\*\*  
CARD TYPE AMEX  
DATE 2025/10/16  
TIME 0081 16:44:08  
RECEIPT NUMBER  
H84101856-001-088-011-0

-----  
PURCHASE  
TOTAL

\$200.00  
-----

AMERICAN EXPRESS  
A000000025010801  
23C4B00ADCA95D4D  
0000008000-E800

**APPROVED**

AUTH# 827635 00-025  
THANK YOU

**NO SIGNATURE REQUIRED**

CARDHOLDER COPY

IMPORTANT - RETAIN THIS  
COPY FOR YOUR RECORDS

KITIKMEOT FOODS LTDQCO  
15 MITIK ST  
CAMBRIDGE BAYNT

CARD \*\*\*\*\*  
CARD TYPE AMEX  
DATE 2025 / 10 / 16  
TIME 9648 16:43:41  
RECEIPT NUMBER  
H84101856-001-088-010-0

-----  
PURCHASE  
TOTAL

**\$200.00**  
-----

AMERICAN EXPRESS  
A000000025010801  
F54A2088DB35A1DB  
0000008000-E800

**APPROVED**

AUTH# 867962 00-025  
THANK YOU

**NO SIGNATURE REQUIRED**

CARDHOLDER COPY

IMPORTANT - RETAIN THIS  
COPY FOR YOUR RECORDS



# KITIKMEAT FOODS LTD.

Box 2268

Cambridge Bay, NUNAVUT X0B 0C0  
(867) 983-2801 Fax (867) 983-2801

CUSTOMER ORDER NO.

TELEPHONE

DATE

Oct. 16

NAME

OTC

ADDRESS

CASH	CHARGE	CHEQUE	DEBIT CARD	C.O.D.	ON ACCT.	MDSE. RET'D.	PAID OUT
	900 Fillet				9.3		
	P.F.F.				2.96		
	Carded x 8				287-25		

SPECIAL INSTRUCTIONS

SUBTOTAL

HST / GST

PST

SOLD BY

RECEIVED BY

TOTAL

727.71

10909

Product 609

THANK YOU

# Kalgen's Dis & Dat Inc.

GST #729951731RT0001  
5 Omilik Road P.O. Box 1253  
Cambridge Bay, Nunavut, X0B0C0  
Canada  
(867) 983-3896

## Sales Receipt

03/10/2025 11:05 am

Ticket: 220000126186

Register: Register 1

Employee: Kalik

Items	#	Price
3/8"X48"X8' Plywood 80/ lift	4	\$260.00
2"X2"X8' Spruce 630/Lift	8	\$44.00
U41040 Floor Screw 8 x 1-1/2 (100)	1	\$8.95
Subtotal		\$312.95
GST (\$312.95 @ 5%)		\$15.65
Total Tax		\$15.65
<b>Total</b>		<b>\$328.60</b>

### PAYMENTS

American Express \$200.00

American Express \$128.60

Thank You !



### TRANSACTION DETAILS

**Sale \$200.00**

AMERICAN EXPRESS \*\*\*\*\*1008

Date: 03/10/2025 11:04 am

Method: contactless\_emv

Auth Code: 889950

AID: A000000025010801

APN: AMERICAN EXPRESS

Account Type: credit

Cryptogram: /37A89D7542F34C28

**Sale \$128.60**

AMERICAN EXPRESS \*\*\*\*\*

Date: 03/10/2025 11:05 am

Method: contactless\_emv

Auth Code: 809171

AID: A000000025010801

APN: AMERICAN EXPRESS

Account Type: credit

Cryptogram: /  
B1DE1C85925F6C38



RECEIPT CONFIRMATION



Municipality of Cambridge Bay

P.O. Box 16  
Cambridge Bay, NU X0B-0C0  
Canada  
Phone: (867) 983-4650  
Fax: (867) 983-2193

DOCUMENT NO.: PY057524

DATE PRINTED: 9/29/2025

Batch No.: 3245

Entry No.: 2

AMOUNT RECEIVED 114.50 CAD

FROM Pamela Gross Elder's Palace rental Oct 09th, 2025

SIGNATURE

PAID BY: AMEX

CHECK/RECEIPT NO.: 000003245-00002

DATE RECEIVED: 9/29/2025

Balance Remaining:

DESCRIPTION	AMOUNT
Pamela Gross Elder's Palace rental Oct 09th, 2025	90.00
Key Deposit	20.00
<b>SUB-TOTAL:</b>	110.00
<b>TAXES:</b> ITC	4.50
<b>TOTAL INCLUDING TAXES:</b>	114.50



### Elder's Palace Rental form

Po Box 16, Cambridge Bay NU, X0B 0C0, 867 983 4650 (p) 867 983 2193 (f)

#### Rental Information

Business/organization Name	Contact Person
Contact Phone Number	Pamela Gross
	Contact Email Address
Date(s) of the event	Time
October 9th, 2025	11 am - 2 pm

Please fill out the following information if you would like to pay with an invoice / LCA. The invoice / LCA must accompany this form. Please include the \$200 damage deposit in the total cost and when you ask to be invoiced after we will consider it as full payment.

Department	billing Address including postal code
	Cambridge Bay NU.

#### User Group Policies

1. If any cleaning after the event has to be done by hamlet staff the \$200 dmg. deposit will not be refunded.
2. Any damage to property during your event will be your responsibility and you will be invoiced for the difference above \$200
3. A walk-in / walk-out will be conducted by the Facility Maintaner who will decide if your damage deposit will be refunded.
4. You are required to clean the Elder's Palace immediately following your event before you leave.
5. Any one that contravenes this policy will not be allowed to hld their next function until approved by the SAO.

I have read and I understand the above policies and agree to abide by them.

Signature: Pam Gross Date: Sept. 29/25

#### Fees gst will be added to final price

Elder's Palace Rental Fees	\$30 an hour
Cleaning fee	\$200
Damage deposit <i>Key deposit</i>	<del>\$200</del> <i>2000</i>
Set up Fee	\$100

#### Elder's Palace Rental

# of Hours	Hourly Rate	Cost for rental rental (automatically calculates)
3	\$30.00	90.00
Total from Above		90.00
<b>Extra Fees</b>		
Do you require us to set up for you? If so enter \$100----->		
Do you require us to clean up for you? If so enter \$200----->		
Sub total of all fees (cost automatically generates for you) ----->		90.00
Tax 5% (automatically generates automatically)----->		4.50
Total for all fees including tax (generates automatically)----->		
Damage Deposit (must be paid upfront or included in PO or LCA)		20.00
Grand total including Damage deposit & GST please make check, PO, LCA or Visa authorization form out for this amount		114.50

The acceptable methods of payment are cash, cheque, debit, VISA, and purchase orders or an LCA. All payments need to be made to the hamlet of Cambridge Bay in order to finalize your booking. We require full payment prior to any organization using the Elder's Palace. Full payment includes all payment types mentioned above and must include the \$200 damage deposit.

### Credit Card Authorization Form

Only needed if you are paying using a credit card

Name on Credit Card	
Credit Card Number	
Expiration Date	
CVC Number (on back of the card)	
Billing Address	
City/Province/Postal Code	

I allow the Hamlet of Cambridge Bay to charge my credit card \$\_\_\_\_\_ for the rental of the Elder's Palace. I also agree that all the information is accurate and complete. I also acknowledge that all orders, rentals etc. may be immediately terminated at the Municipality of Cambridge Bay's discretion if any charges are declined or charge backs are claimed against any outstanding invoiced amounts. Disputes to amounts charged should be immediately be reported to the Municipality of Cambridge Bay.

Authorizing signature: \_\_\_\_\_

Date: \_\_\_\_\_

----- TRANSACTION RECORD -----

**HAMLET OF CAMBRIDGE BAY**  
65 NATIK ST  
CAMBRIDGE BAYNT

## Purchase

Sep 29, 2025 16:37:48

AMEX \*\*\*\*\*

TID: \*\*\*\*\*352 Entry: Tap EMV (H)

Sequence: 218 081

Auth#: 825811 Response: 00-025

Batch: 218

Amount \$ 204.25

**Total \$ 204.25**

A000000025010801  
AMERICAN EXPRESS  
TVR 0000008000

## Approved

Signature Not Required

Important: Retain this copy for your record

Cardholder copy

-----TRANSACTION RECORD-----  
HAMLET OF CAMBRIDGE BAY  
65 NATIK ST  
CAMBRIDGE BAYNT

## Purchase

Sep 29, 2025 16:37:01  
AMEX \*\*\*\*\*  
TID: \*\*\*\*\*352 Entry: Tap EMV (H)  
Sequence: 218 080  
Auth#: 888699 Response: 00-025  
Batch: 218

Amount \$ 200.00

**Total \$ 200.00**

A000000025010801  
AMERICAN EXPRESS  
TVR 0000008000

**Approved**  
Signature Not Required

Important: Retain this copy for your record

Cardholder copy

----- TRANSACTION RECORD -----

**HAMLET OF CAMBRIDGE BAY**  
65 NATIK ST  
CAMBRIDGE BAYNT

## Purchase

Sep 29, 2025 16:36:24  
AMEX \*\*\*\*\*  
TID: \*\*\*\*\*352 Entry: Tap EMV (H)  
Sequence: 218 079  
Auth#: **808410** Response: 00-025  
Batch: 218

Amount \$ 200.00

**Total \$ 200.00**

A000000025010801  
AMERICAN EXPRESS  
TVR 0000008000

**Approved**  
Signature Not Required

Important: Retain this copy for your record

Cardholder copy

RECEIPT CONFIRMATION



Municipality of Cambridge Bay

P.O. Box 16  
Cambridge Bay, NU X0B-0C0  
Canada  
Phone: (867) 983-4650  
Fax: (867) 983-2193

DOCUMENT NO.: PY057525

DATE PRINTED: 9/29/2025

Batch No.: 3245

Entry No.: 3

AMOUNT RECEIVED 604.25 CAD

FROM Pamela Gross Community Hall Rental Oct 17, 2025

SIGNATURE

PAID BY: AMEX

CHECK/RECEIPT NO.: 000003245-00003

DATE RECEIVED: 9/29/2025

Balance Remaining:

DESCRIPTION	AMOUNT
Pamela Gross Community Hall Rental Oct 17, 2025	385.00
Damage Deposit	200.00
<b>SUB-TOTAL:</b>	585.00
<b>TAXES:</b>	ITC 19.25
<b>TOTAL INCLUDING TAXES:</b> 604.25	



**Luke Novoligak Community Hall Rental form**

Po Box 16, Cambridge Bay NU, X0B 0C0, 867 983 4650 (p) 867 983 2193 (f)

**Rental Information**

<b>Business/organization Name</b>	<b>Contact Person</b>
	Pamela Gross
<b>Contact Phone Number</b>	<b>Contact Email Address</b>
<b>Date(s) of the event</b>	<b>Time</b>
October 17, 2025	3pm - 7pm
<b>Purpose of Rental:</b>	Campaign

Please fill out the following information if you would like to pay with an PO / LCA. The PO / LCA must accompany this form. Please include the \$200 damage deposit in the total cost.

<b>PO / LCA Number</b>	<b>Billing address including postal code</b>
	2-61 Kalaak St. Cambridge Bay, NU.

**FEES**

Businesses, Government agencies, Inuit Organizations, & all other non-local organizations	\$105 an hour \$750 per day
Resale Dance, Weddings, Bingos, and/or lotteries	\$750
Meetings for local charities, sports groups, youth events & individuals	\$40 an hour \$300 per day
Sound system & mikes, projector etc. per day	\$125
Cleaning fee	\$200
Set up fee	\$100
Damage deposit	\$200

GST will be added to final price

# of Hours per day or # of days	Hourly Rate or Daily rate (see rates above)	Cost for hall rental (automatically calculates)
	\$750.00	
	\$105.00	
4	\$40.00	\$160.00
	\$300.00	
<b>Total from Above</b>		

**Extra Fees**

Do you require us to set up for you? If so enter \$100----->	\$100.00
Do you require us to clean up for you? If so enter \$200----->	
Do You require the sound equipment if yes enter \$125 per day---->	\$125.00
Sub total of all fees (cost automatically generates for you) ----->	385.00
Tax 5% (automatically generates automatically)----->	19.25
<b>Total for all fees including tax (generates automatically)-----&gt;</b>	<b>404.25</b>
Damage Deposit (must be paid upfront or included in PO or LCA)	\$200.00
Grand total including Damage deposit & GST please make check, PO, LCA or Visa authorization form out for this amount	604.25

The acceptable methods of payment are cash, cheque, debit, credit, and purchase orders or an LCA. All payments need to be made to the hamlet of Cambridge Bay in order to finalize your booking. We require full payment prior to any organization using the hall. Full payment includes all payment types mentioned above and must include the \$200 damage deposit.

**User Group Policies**

1. I understand it is my responsibility to pick up the key during regular business hours at the Hamlet Main Office, as there is no one available to unlock the facility. Initials: PG
  2. Hall needs to be booked through the Facility Manager/designate at least 2 weeks in advance
  3. All events must end by 2am unless approved by Hamlet Council.
  4. Last call must be made 30 minutes before closing for any alcohol events.
  5. If any cleaning after the event has to be done by hamlet staff, and was not indicated on the form that it was needed, the \$200 damage deposit will not be refunded.
  6. Any damage to property during your event will be your responsibility.
  7. The person/organization must have an approved operator in order to use the audio equipment.
  8. Please arrange key pick up with the Facility Manager/designate at least 1 business day in advance especially if your rental is on the weekend and/or a holiday.
  9. You are required to clean the hall immediately following your event before you leave.
- \*Anyone that contravenes this policy will be brought to the SAO and Hamlet Council's attention and will not be allowed to hold their next function until approved by the SAO.

If you require us to set up (extra \$100 fee) please mention below your needs and/or draw us a diagram. For example number of chairs, sound equipment needed, business meeting style, or tables/chairs in a horse shoe, projector etc. If needed you can call the Facility Manager to discuss your set up needs.

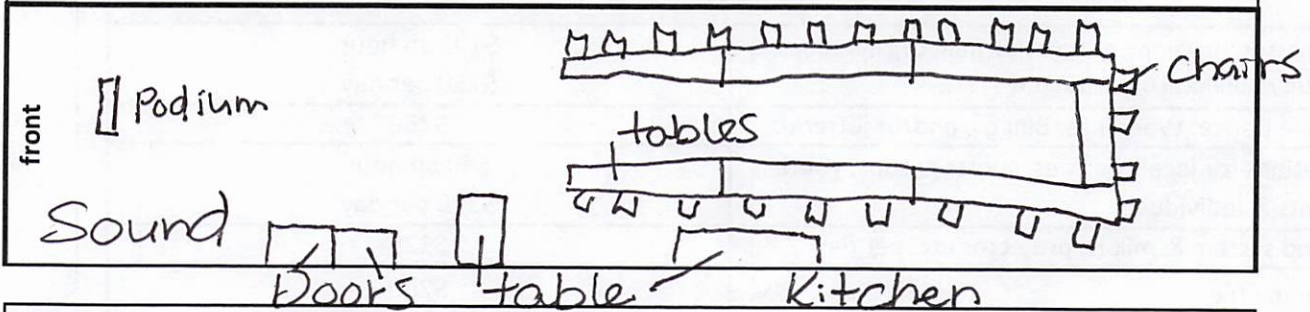

**Credit Card Authorization Form**  
Only needed if you are paying by credit card

Name on Credit Card
Credit Card Number
Expiration Date
CVC Number (on back of the card)
Billing Address
City/Province/Postal Code

I allow the Hamlet of Cambridge Bay to charge my credit card \$ \_\_\_\_\_ for the rental of the community hall. I also agree that all the information is accurate and complete. I also acknowledge that all orders, rentals etc. may be immediately terminated at the Municipality of Cambridge Bay's discretion if any charges are declined or charge backs are claimed against any outstanding invoiced amounts. Disputes to amounts charged should be immediately be reported to the Municipality of Cambridge Bay.

Authorizing signature: \_\_\_\_\_

Date: \_\_\_\_\_